

Install Guide

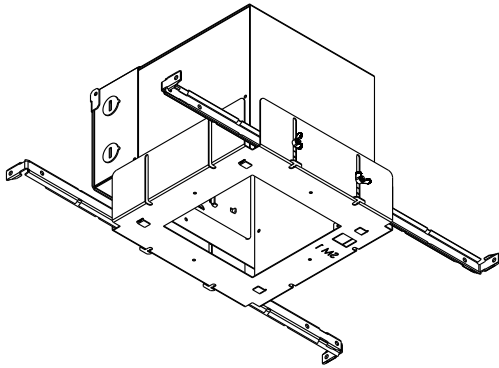

MATRIX LARGE/SMALL HOUSING LED INSTALLATION



This product must be installed in accordance with the applicable code by a person familiar with the construction and operation of the product and the hazards involved. Read all of these instructions before installing.

WARNING: Rated for non-insulated ceilings only (non IC rated)
WARNING: Disconnect power prior to servicing or installing.

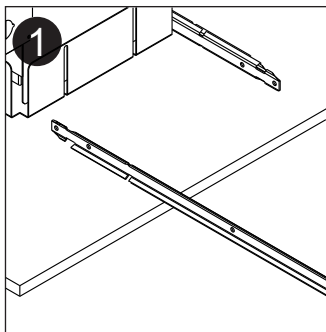

Slide hanger bars into base plate in the desired direction.

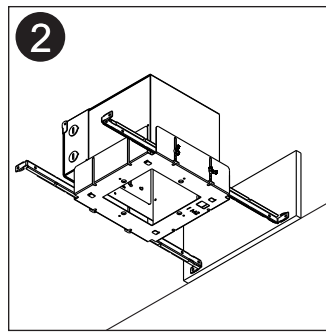

For wood joints bend end tabs 90 degrees.

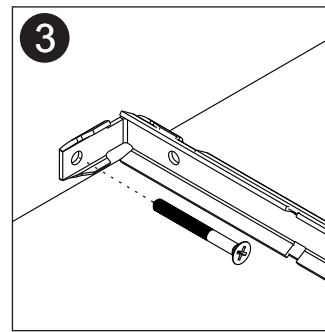

For added security install a nail or screw through the hole.

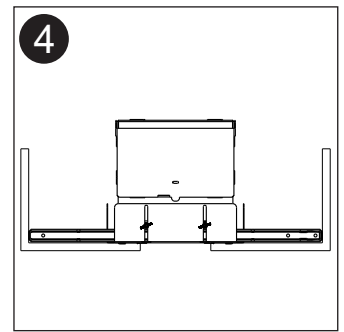

Position base plate to desired location by sliding left/right or up/down.

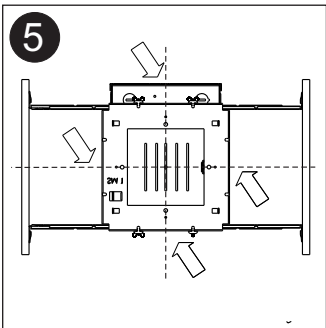

To line up a row of fixtures, use centering holes on either side of base plate.

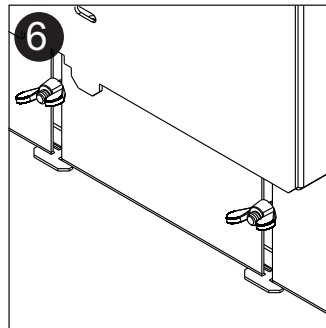

When fixtures is in its desired position, secure in place by tightening wing nuts.

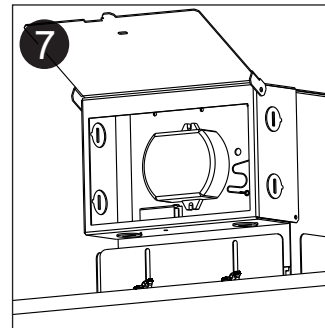

Unhinge lid of electrical box & connect input power to Primary of transformer.

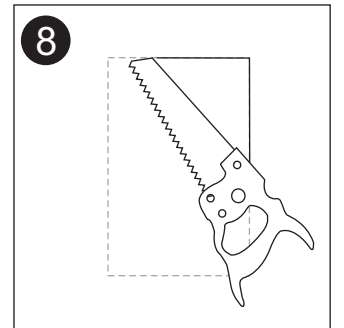

Mark approximate fixture location in ceiling. Cut open using hole as your guide.

MXS1 5 1/4" x 5 1/4"
MXS2 5 1/4" x 10 1/4"
MXS3 5 1/4" x 15 1/4"

MXL1 7 1/4" x 7 1/4"
MXS2 7 1/4" x 14"
MXS3 7 1/4" x 20 3/4"

Matrix [LED]-Installation • Subject to change without notice • REV 2022.12.01

Install Guide



MATRIX LARGE/SMALL MXL/S-T LED TRIMMED INSTALLATION

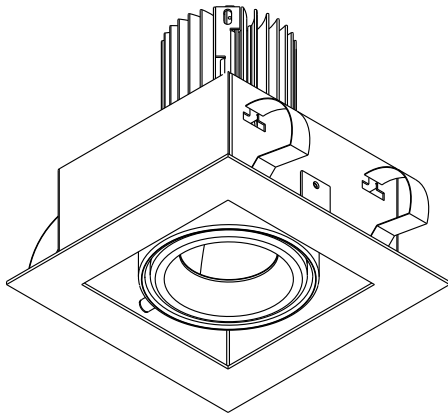

This product must be installed in accordance with the applicable code by a person familiar with the construction and operation of the product and the hazards involved. Read all of these instructions before installing.

WARNING: Rated for non-insulated ceilings only (non IC rated)
WARNING: Disconnect power prior to servicing or installing.

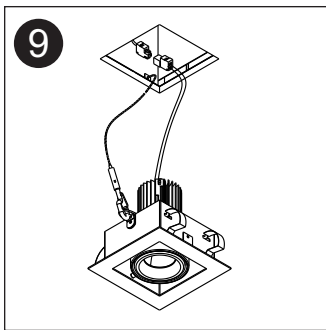

Clip safety hook onto latch on side of trim. Connect wire connector(s) from trim to housing.

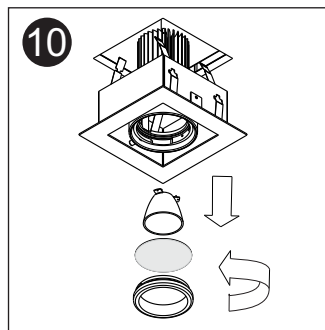

Before installing trim, remove face ring, adapter & reflector by turning all parts counterclockwise.

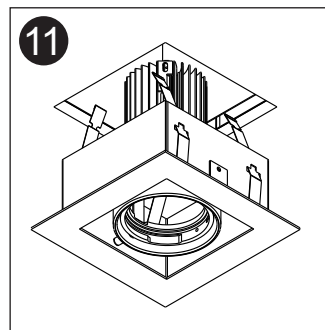

Compress trim clips flat to side of fixture, and then insert trim into ceiling cutout.

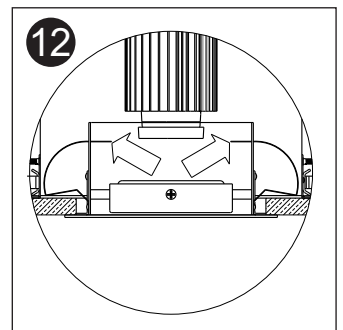

With trim pushed into ceiling, push the end of each clip outwards until they lock in place.

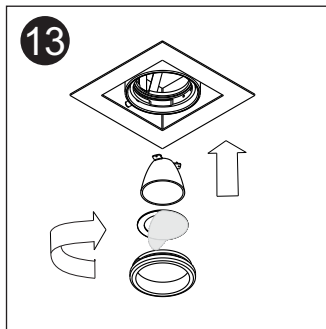

Remove protective film over adapter. Re-install reflector, adapter and face ring.

Glass Lens Option

To Install an optional glass lens, twist counter-clockwise to release front ring, turn ring until tabs line up & ring drops out. Install glass lens into adaptor ring. (Glass Lens ordered separately)

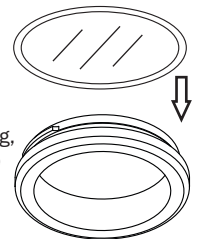

Install Guide



MATRIX LARGE/SMALL MXL/S-TL LED TRIMLESS INSTALLATION

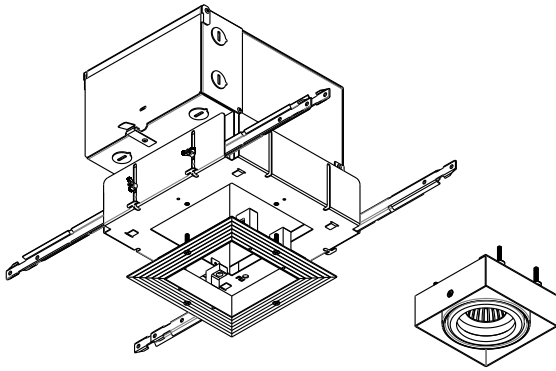

This product must be installed in accordance with the applicable code by a person familiar with the construction and operation of the product and the hazards involved. Read all of these instructions before installing.

WARNING: Rated for non-insulated ceilings only (non IC rated)
WARNING: Disconnect power prior to servicing or installing.

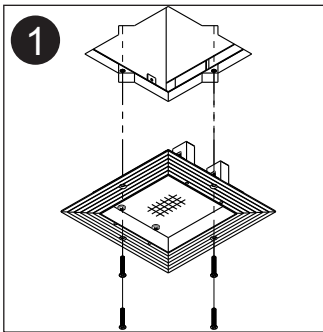

See MATRIX BASEPLATE TRIMMED for basplate mounting (steps 1-8).

Expose mounting hardware on base plate. Install trimless frame with screws provided.

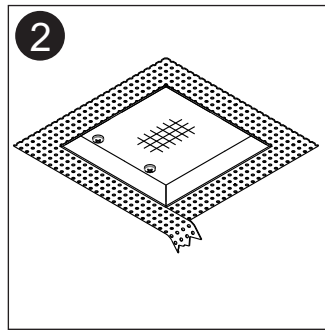

Apply fibre mesh tape (provided) over trimless frame edge. Remove excess tape.

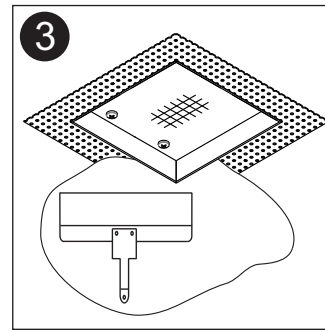

Apply thin coat of plaster mud onto trimless frame, using frame lip as the height guide. For best results feather mud 12" from hole edge.

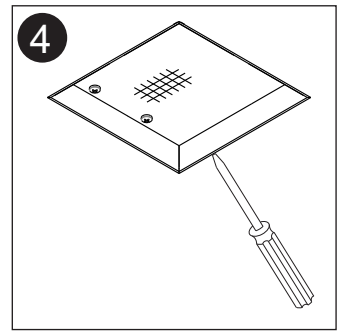

Use a small screwdriver or straightedge to clean the inside edge of the trimless frame of any excess drywall mud.

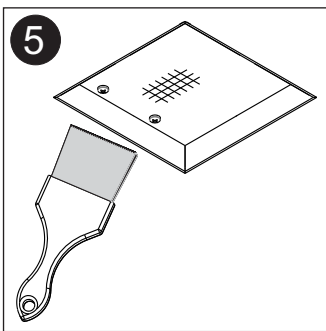

Paint ceiling. Excess paint on inside edge of frame may restrict the trim from sitting flat.

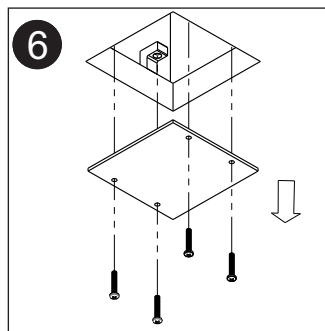

Remove protective cardboard cover. Screws not required further.

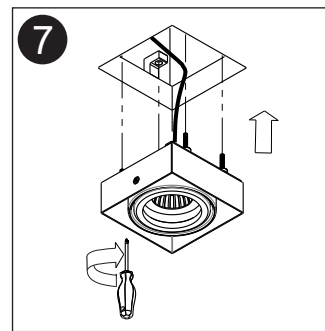

Insert trim assembly into place and secure with (4) captive screws.

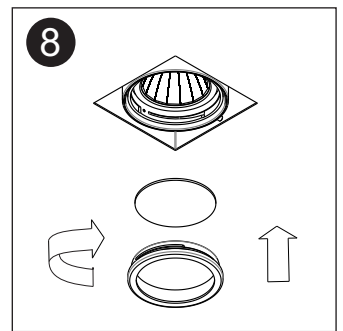

To install an optional glass lens, twist counter-clockwise to release front ring, turn ring until tabs line up & ring drops out. Install glass lens into face ring. **(Glass Lens ordered separately)**

Matrix [LED]-Installation • Subject to change without notice • REV 2022.12.01