

## Legacy Housings

2-065 | Incandescent

### Square High Watt Non-Insulated

#### FEATURES

- Rated for non-insulated ceilings
- 14"-25" adjustable hanger bars
- 20 Ga. cold rolled steel baseplate
- 18 Ga. galvanized steel junction box
- 5 junction box knock outs
- MR16 porcelain Bi Pin socket type GX5.3
- MR16 low voltage (12V) lamp sold separately
- Over lamping protection
- Transformer accessible through the ceiling
- Approved for branch circuit wiring

#### CEILING CUTOUT

3 7/8" [99mm] X 3 7/8" [99mm]

#### PERFORMANCE SUMMARY

Lamp	Series	Input Voltage		
		120V	277V	347V
		Maximum Wattage		
MR16	Magnetic Transformer	75W	75W	75W
MR16	Electronic Transformer	75W	75W	—
MR16	E15 Electronic Transformer	75W	75W	—
MR16	Magnetic Potted, Epoxy Encapsulated Transformer	75W	—	—
GU10	GU10 Halogen Lamp	75W	—	—
GU10	GU10 LED Lamp	75W	—	—

#### DIMENSIONS—TRIMMED

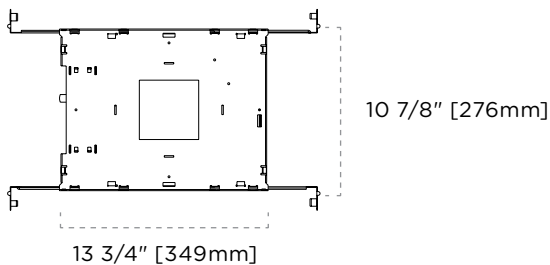

Combustible Material

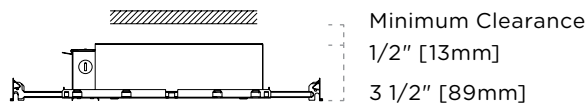

#### DIMENSIONS—TRIMLESS

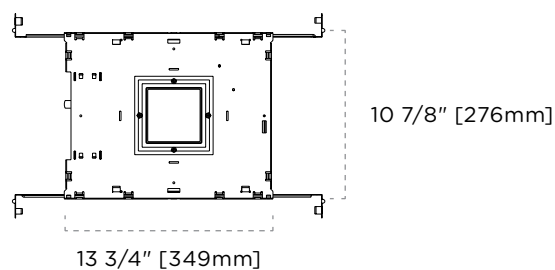

Combustible Material

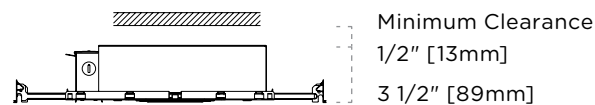

#### CERTIFICATIONS



# Legacy Housings

2-065 | Incandescent

## Square High Watt Non-Insulated

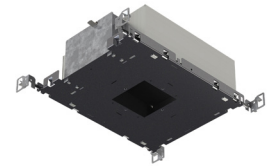

### TAG TYPE

### ORDER FORM

1	2	3	4	5

#### 1. HOUSING

**2-065** Square High Watt

#### 2. HOUSING TYPE

**F-Q** Non-Insulated

**F-Q-TL** Trimless Non-Insulated

#### 3. TRANSFORMER

**E** MR16 Electronic Transformer  
(Halogen Lamp)

**E15** MR16 Electronic Transformer  
(Halogen Replacement Lamp)<sup>1</sup>

**M** MR16 Magnetic Transformer

**MPT** MR16 Magnetic Potted  
Transformer<sup>2</sup>

**TOR** MR16 Q-Tran Toroidal Magnetic  
Transformer

#### 4. VOLTAGE

**120**

**277**

**347**<sup>3</sup>

#### 5. OPTIONS

**BP** Black Painted Interior

**WP** White Painted Interior

#### NOTES

**1** E15 transformer is rated for a maximum 15W, lamp sold separately. Ensure lamp and dimmer compatibility with lamp manufacturer.

**2** MPT transformer option is available in 120 voltage and increases housing height to 4.5".

**3** 347 voltage is only available with M magnetic transformer.