

Install Guide

2-060-F SERIES MR16 HIGH WATTAGE NON-I/C HOUSING

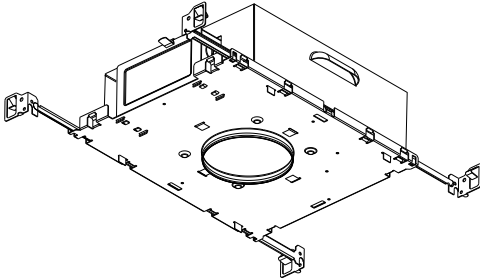

This product must be installed in accordance with the applicable code by a person familiar with the construction and operation of the product and the hazards involved. Read all of these instructions before installing.

WARNING: Rated for non-insulated ceilings only (non IC rated)
WARNING: Disconnect power prior to servicing or installing.

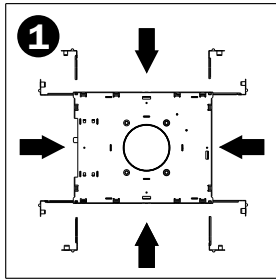

1 Choose direction hanging bars are to be inserted. Slide hanging bars onto housing base plate

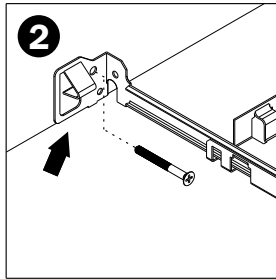

2 Line up bottom edge of hanging bars with bottom of wood joist and hammer in tabs. Nail or screw hanging bars into place

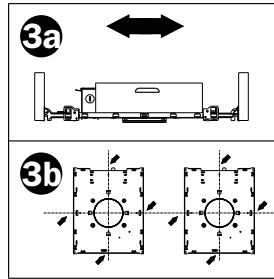

3a – Position trim hole to desired location by sliding housing
3b – Use centering holes on either side of housing base plate to line up a row of fixtures

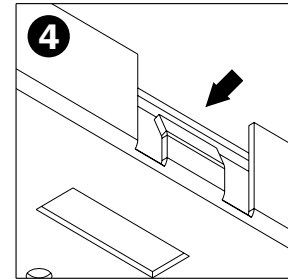

4 To hold housing in place, bend tab with pliers into hanging bar

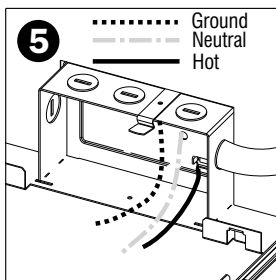

5 Remove knock out and make appropriate electrical connection

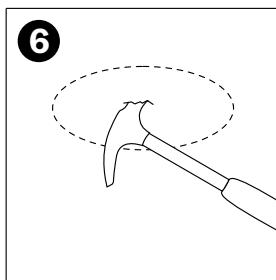

6 Mark approximate fixture location in ceiling

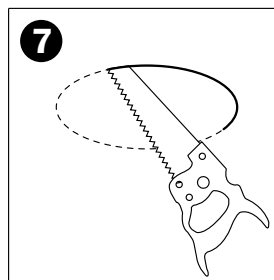

7 Cut open using trim hole as your guide

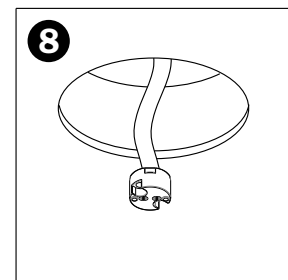

8 Socket hangs through hole until completion



Install Guide

2-060-F-D/A SERIES MR16 HIGH WATTAGE DEEP NON-I/C HOUSING

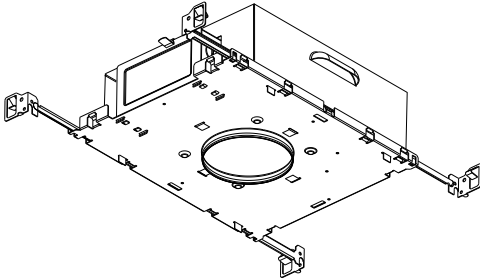

This product must be installed in accordance with the applicable code by a person familiar with the construction and operation of the product and the hazards involved. Read all of these instructions before installing.

WARNING: Rated for non-insulated ceilings only (non IC rated)
WARNING: Disconnect power prior to servicing or installing.

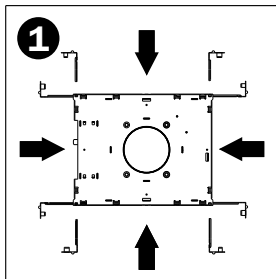

1 Choose direction hanging bars are to be inserted. Slide hanging bars onto housing base plate

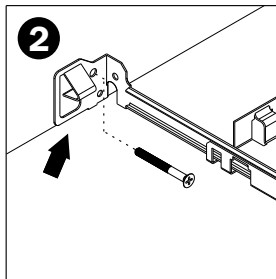

2 Line up bottom edge of hanging bars with bottom of wood joist and hammer in tabs. Nail or screw hanging bars into place

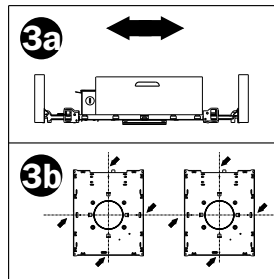

3a – Position trim hole to desired location by sliding housing
3b – Use centering holes on either side of housing base plate to line up a row of fixtures

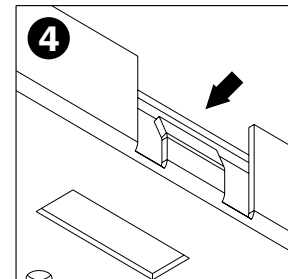

4 To hold housing in place, bend tab with pliers into hanging bar

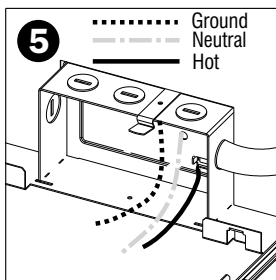

5 Remove knock out and make appropriate electrical connection

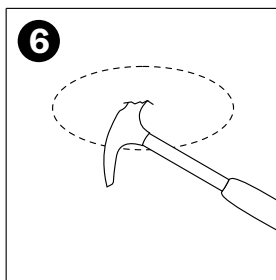

6 Mark approximate fixture location in ceiling

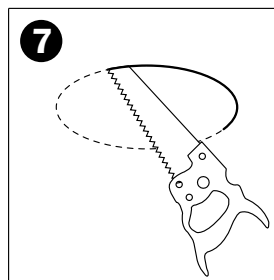

7 Cut open using trim hole as your guide

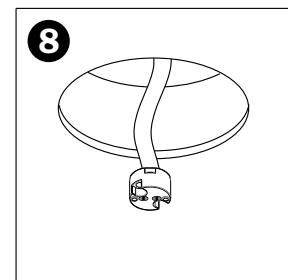

8 Socket hangs through hole until completion



Install Guide

2-060-F SERIES MR16 HIGH WATTAGE NON-I/C HOUSING

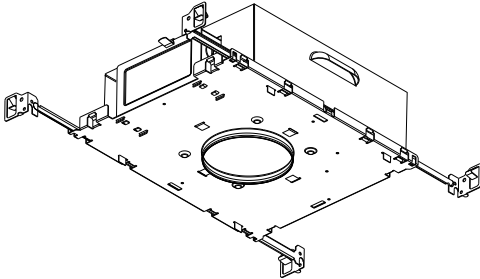

This product must be installed in accordance with the applicable code by a person familiar with the construction and operation of the product and the hazards involved. Read all of these instructions before installing.

WARNING: Rated for non-insulated ceilings only (non IC rated)
WARNING: Disconnect power prior to servicing or installing.

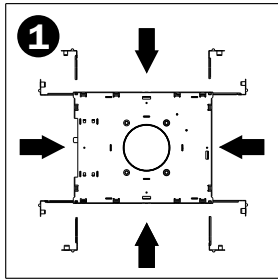

1 Choose direction hanging bars are to be inserted. Slide hanging bars onto housing base plate

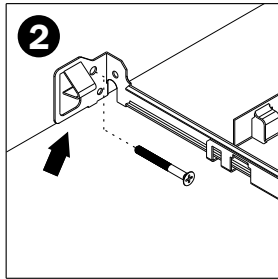

2 Line up bottom edge of hanging bars with bottom of wood joist and hammer in tabs. Nail or screw hanging bars into place

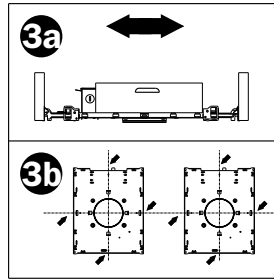

3a – Position trim hole to desired location by sliding housing
3b – Use centering holes on either side of housing base plate to line up a row of fixtures

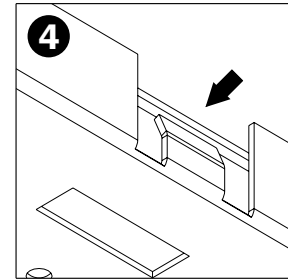

4 To hold housing in place, bend tab with pliers into hanging bar

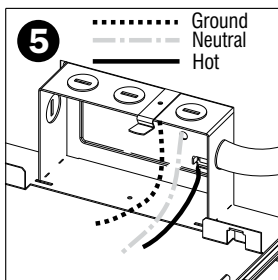

5 Remove knock out and make appropriate electrical connection

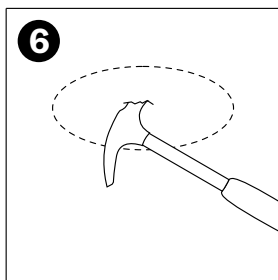

6 Mark approximate fixture location in ceiling

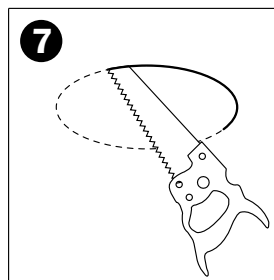

7 Cut open using trim hole as your guide

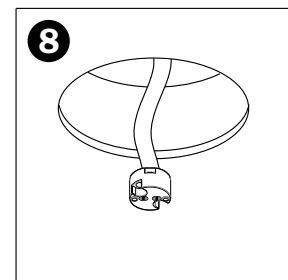

8 Socket hangs through hole until completion



Install Guide

2-060-F-T/L SERIES HIGH WATT TRIMLESS NON-I/C HOUSING

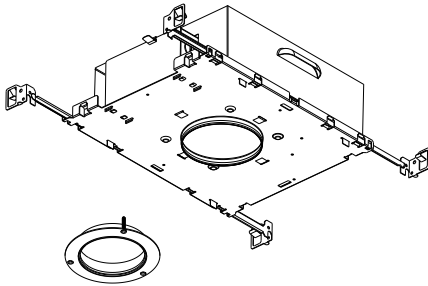

This product must be installed in accordance with the applicable code by a person familiar with the construction and operation of the product and the hazards involved. Read all of these instructions before installing.

WARNING: Rated for non-insulated ceilings only (non IC rated)
WARNING: Disconnect power prior to servicing or installing.

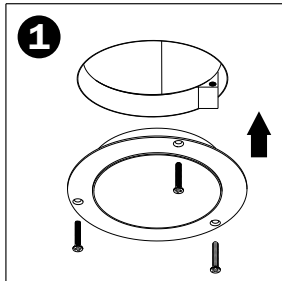

After drywall is cutout, cut notches to expose mounting holes on housing baseplate and install trimless frame with screws provided

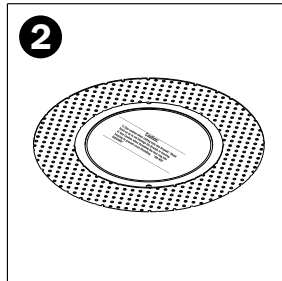

Apply factory supplied fibre mesh over trim collar edge. Insert cardboard cover into opening

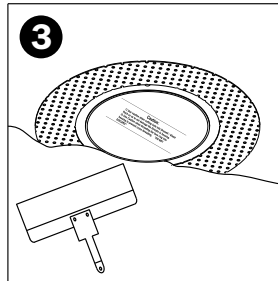

Apply thin coat of plaster mud onto trim collar and fibre mesh, using collar lip as the height guide. For best results feather mud 12" from edge of lip

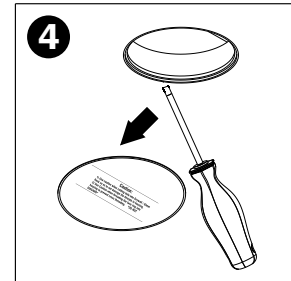

Remove cardboard cover. Use a small screwdriver to clean the inside lip of the trim collar of any excess drywall mud

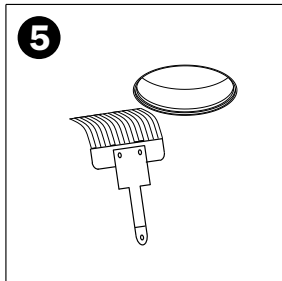

Paint ceiling. Excess paint on inside edge of ring may restrict the trim from sitting flat

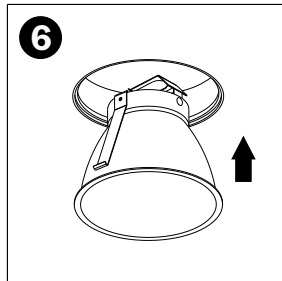

Socket hangs through hole until completion. Install lamp into trim and socket. Snap trim ring into finished hole



Install Guide

2-060-F-D/A SERIES MR16 HIGH WATTAGE DEEP NON-I/C HOUSING

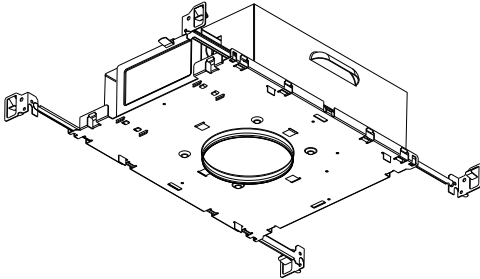

This product must be installed in accordance with the applicable code by a person familiar with the construction and operation of the product and the hazards involved. Read all of these instructions before installing.

WARNING: Rated for non-insulated ceilings only (non IC rated)
WARNING: Disconnect power prior to servicing or installing.

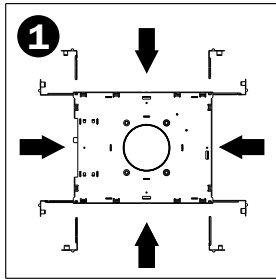

1 Choose direction hanging bars are to be inserted. Slide hanging bars onto housing base plate

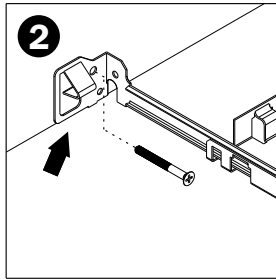

2 Line up bottom edge of hanging bars with bottom of wood joist and hammer in tabs. Nail or screw hanging bars into place

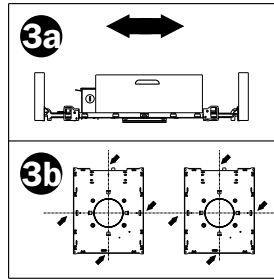

3a – Position trim hole to desired location by sliding housing
3b – Use centering holes on either side of housing base plate to line up a row of fixtures

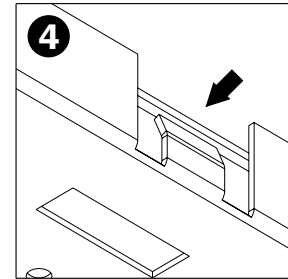

4 To hold housing in place, bend tab with pliers into hanging bar

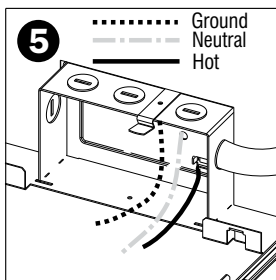

5 Remove knock out and make appropriate electrical connection

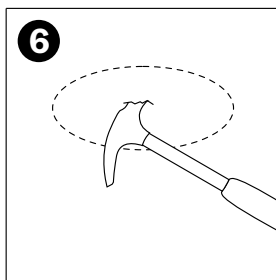

6 Mark approximate fixture location in ceiling

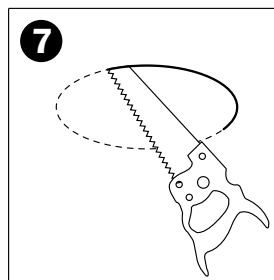

7 Cut open using trim hole as your guide

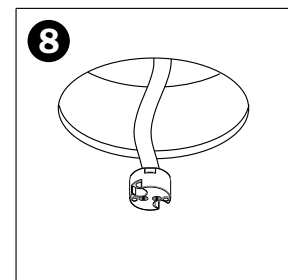

8 Socket hangs through hole until completion



Install Guide

2-060-F-T/L-D/A SERIES HIGH WATT TRIMLESS DEEP NON-I/C HOUSING

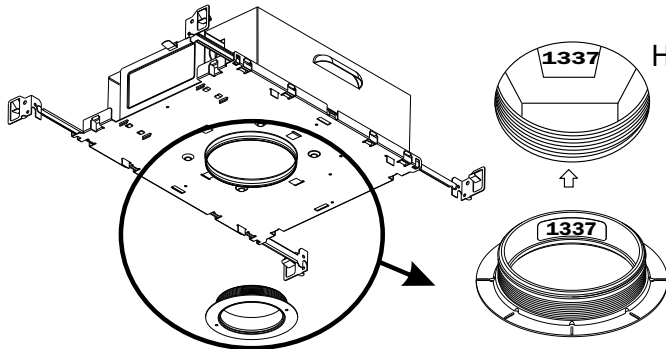

Note:

- When removing or installing trim collar, make sure number on inside of collar matches number on inside of housing.

- This is a crucial step due to ring sets are matched at factory in order to prevent cross threading.

- Make sure there is no dry wall dust or other debris in threads as this may cause ring set to stick.

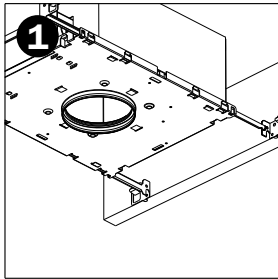

Threaded ring attached to housing base plate is visible before drywall is installed

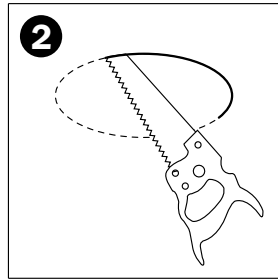

After installing drywall, cut open using trim hole as your guide. Trim hole cutout is 4 1/2". Keep threads clean

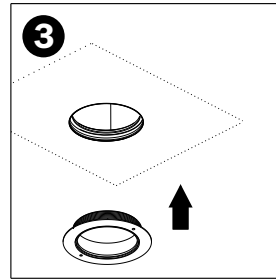

After drywall is cutout, thread trim collar into threaded ring until snug onto drywall. The trim collar is designed to work with drywall up to 1" thick

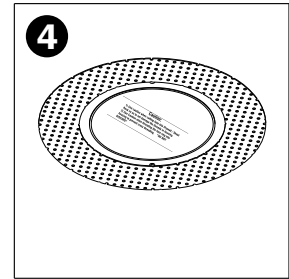

Apply factory supplied fibre mesh over trim collar edge. Insert cardboard cover into opening

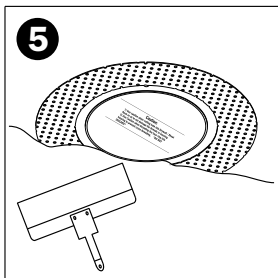

Apply thin coat of plaster mud onto trim collar and fibre mesh, using collar lip as the height guide. For best results feather mud 12" from edge of lip

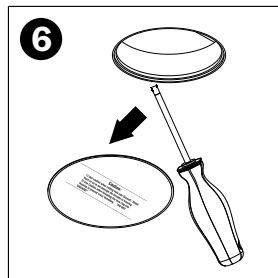

Remove cardboard cover. Use a small screwdriver to clean the inside lip of the trim collar of any excess drywall mud

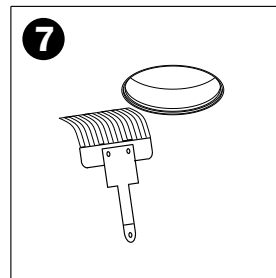

Paint ceiling. Excess paint on inside edge of ring may restrict the trim from sitting flat

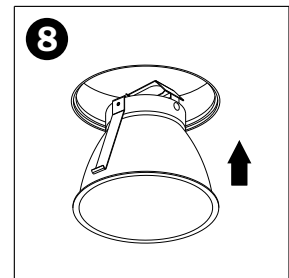

Socket hangs through hole until completion. Install lamp into trim and socket. Snap trim ring into finished hole

